

Loader Manual

Name	Model
L135SL	RK74

Mark	Date.	Specification

※ Bolt, Nut tightening torque

Please adhere to standard down figure when is tightening nut and bolts.

Configur ation item	Hexagon head bolt, Nut tightening torque (kgf-cm)			
	NO	Bolts, Nuts size	9T	7T
1	M5	-	60~70	30~40
2	M6	-	100~130	60~80
3	M8	-	250~350	130~180
4	M10	-	550~700	200~300
5	M12	1,150~1,280	900~1,100	500~600
6	M14	1,840~2,040	1,300~1,500	700~800
7	M16	2,840~3,160	1,600~1,800	1,000~1,200
8	M18	3,930~4,360	2,000~2,400	1,200~1,400
9	M20	5,550~6,170	2,400~2,600	1,500~2,600

2)Hydraulic fitting screwing torque

: 1/4" : 250 kgf-cm, 3/8" : 500 kgf-cm, 1/2" : 600 kgf-cm

3rd Function KIT

INSTALLATION

L135SL

HYDRAULIC PIPING ASSEMBLY

Year / Month

2018 / 10

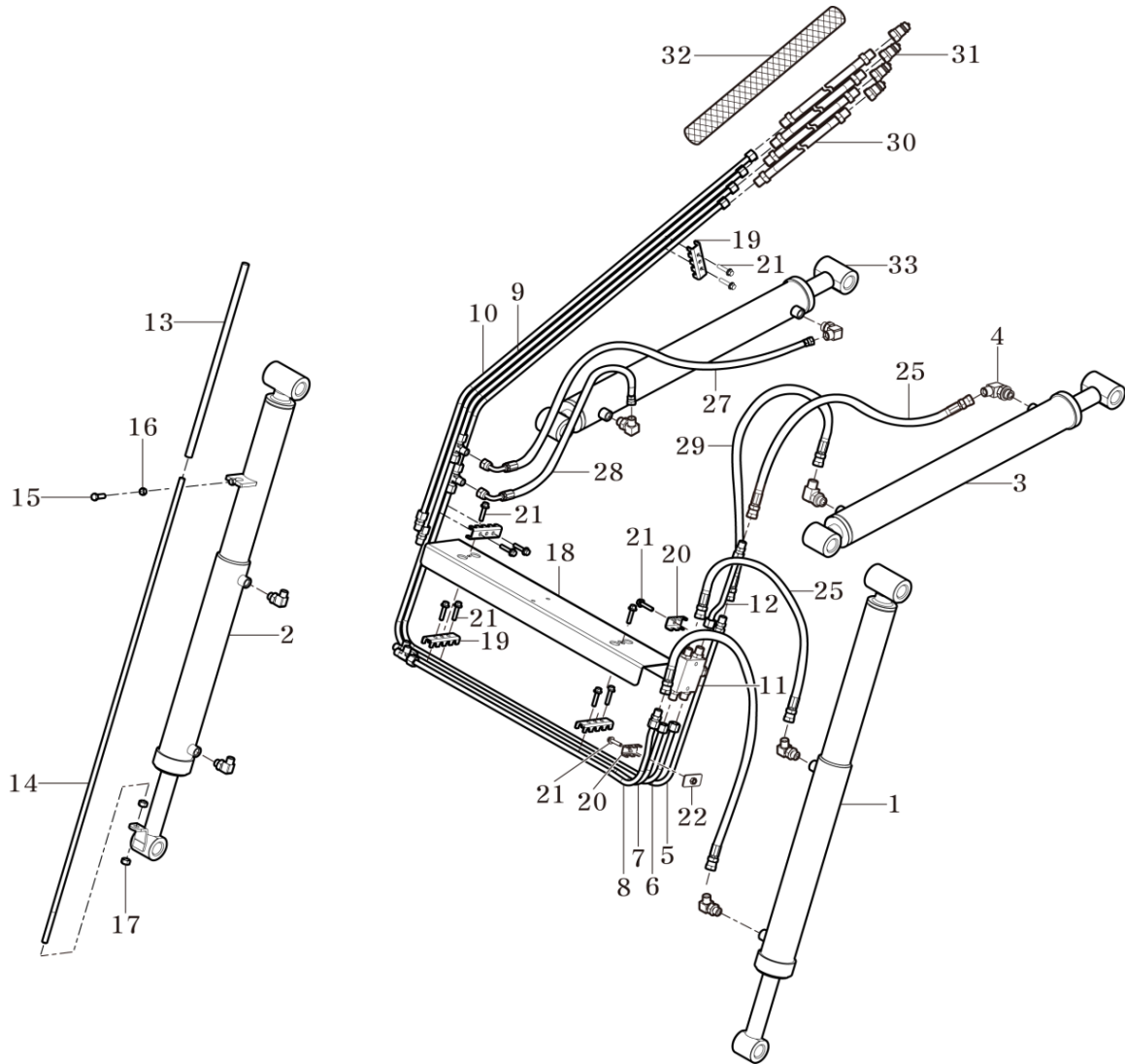
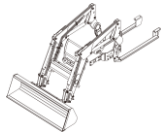

3rd Function KIT

INSTALLATION

L135SL

3rd FUNCTION KIT

Year / Month

2018 / 10

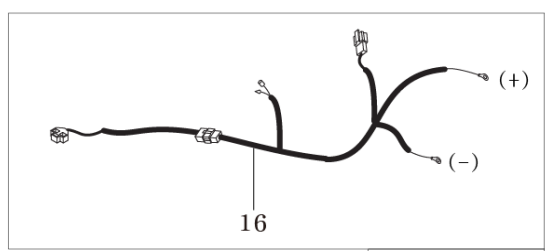
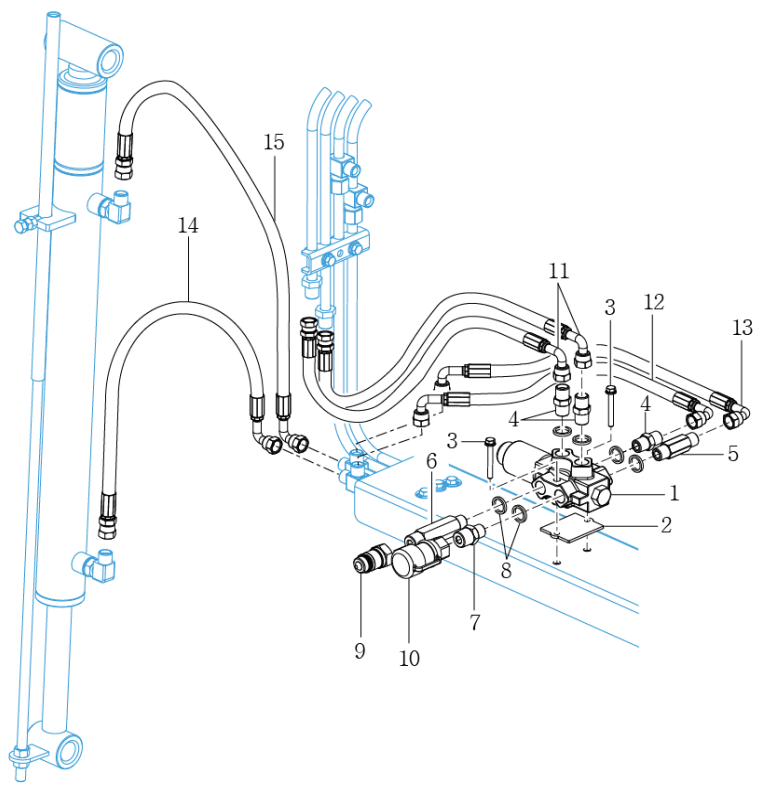
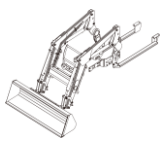

1. Disassembly of pipe and Hydraulic Hose

- A : PIPE ASSY ROLLBACK
- B : PIPE ASSY DUMP
- a1 : Hydraulic Hose sub (Reassemble after disassembly)
- b1 & b2 : Hydraulic Hose
- C : Cover Pipe

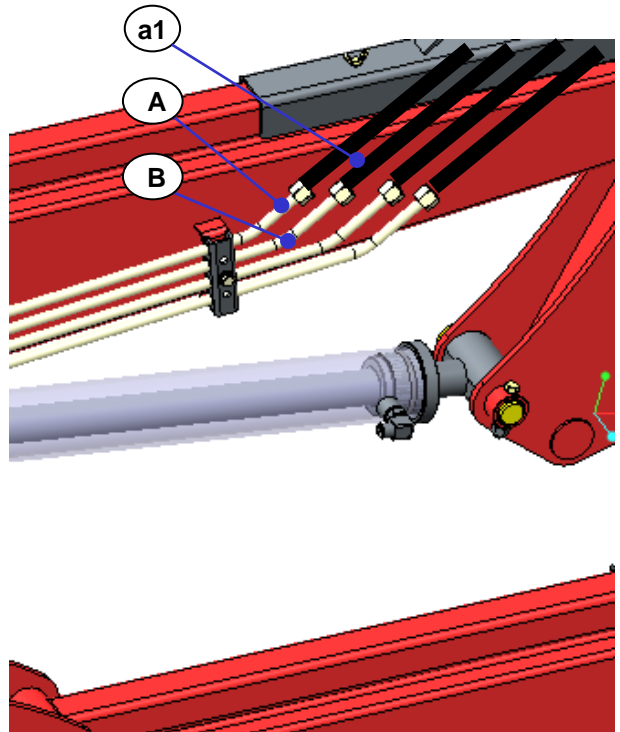
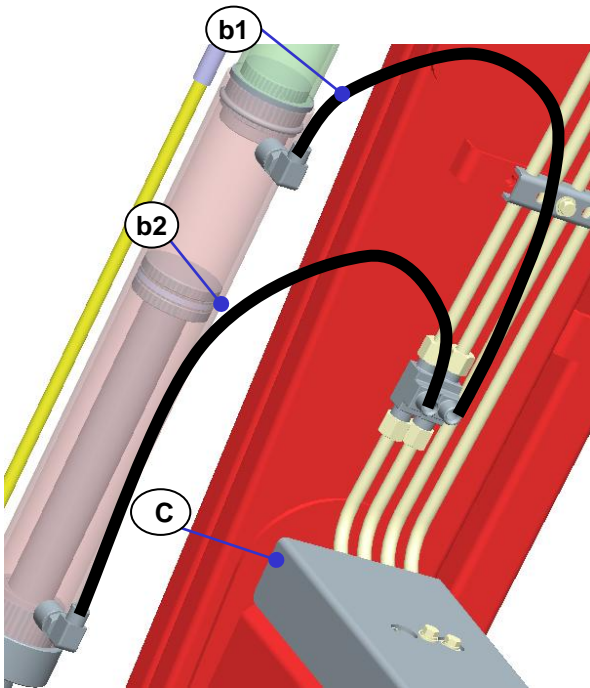

2. Assembly of 3rd Function Pipe

- 1) : PIPE ASSY , A UPPER (No. 09)
- 2) : PIPE ASSY , B UPPER (No. 10)
- 3) : PIPE ASSY , C (No. 07)
- 4) : PIPE ASSY , F (No. 08)
- 5) : BRACKET B (No. 20)
- 6) : PLATE COMP , PIPE C (No. 21)
- 7) : BOLT M8 X 40L (1EA) (No. 22)

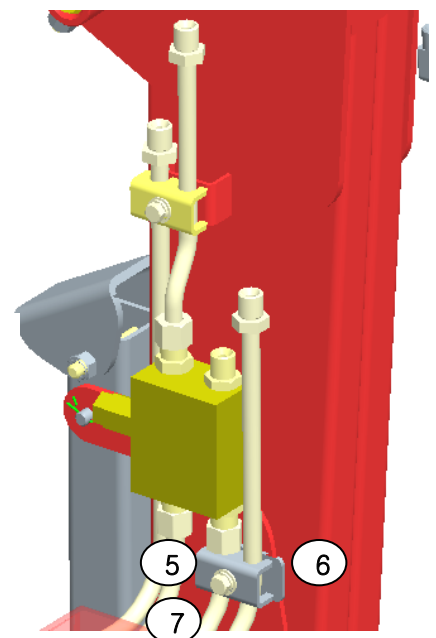
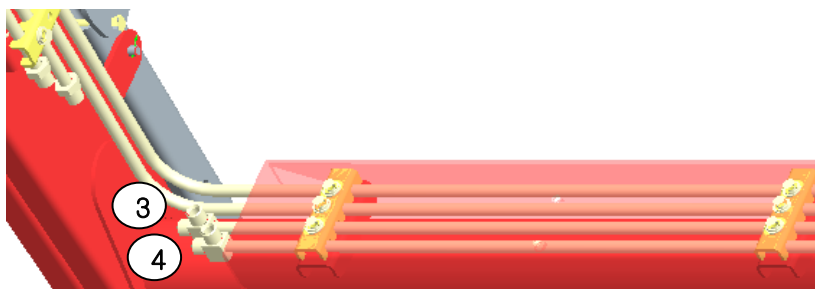
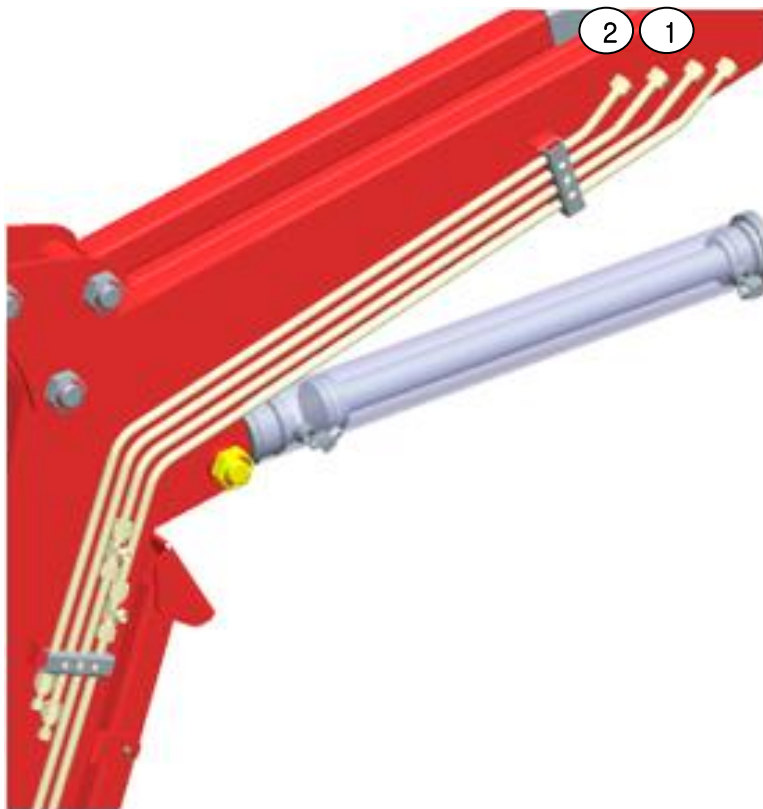

3. Assembly of Diverter valve sub

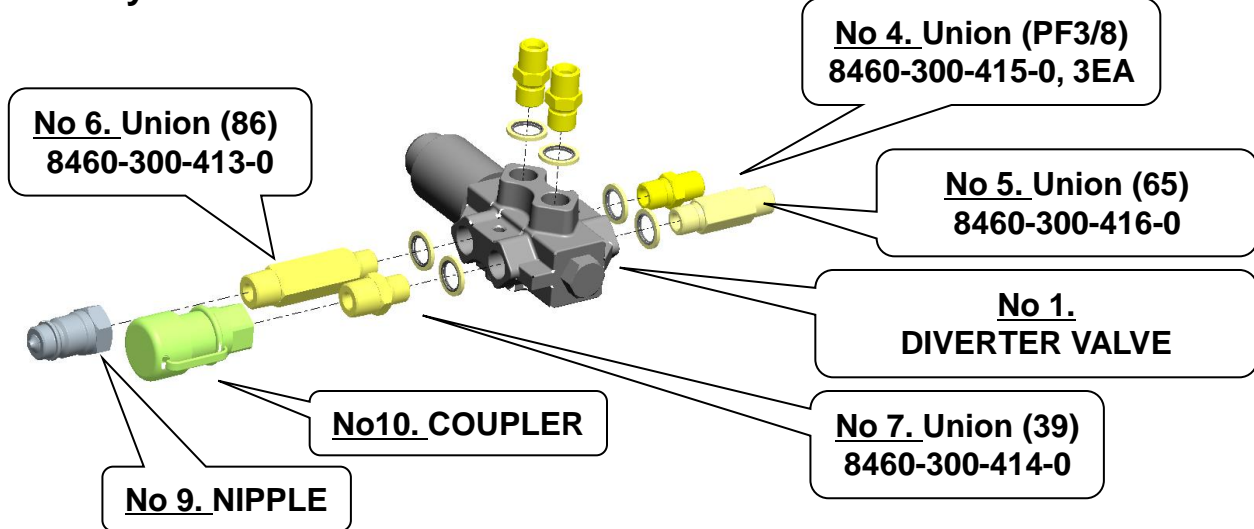

※ Assembly Bonded Seal (No 8. 590-300-505-0) before assembly Union.

4. Assembly of Diverter valve sub

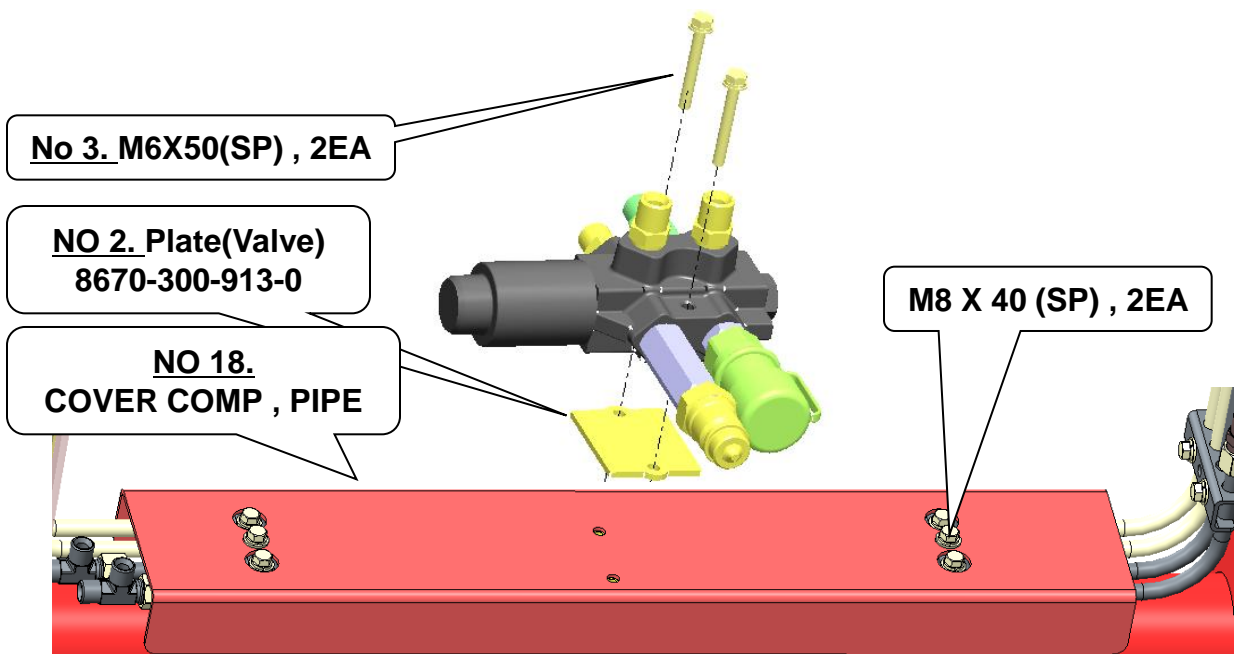

5. Assembly of 3rd Function Hydraulic Hoes

No 13. 8460-300-402-1
Hydraulic hose(440/90°)

No 12. 8460-300-401-0
Hydraulic hose(390/90°)

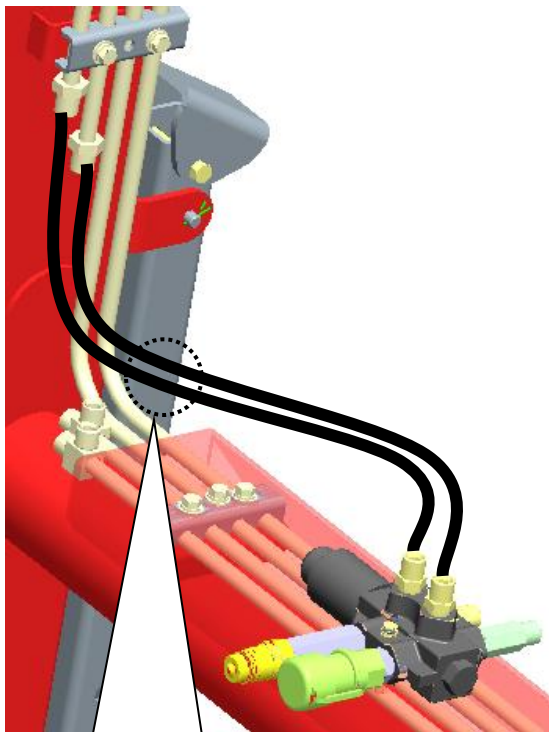
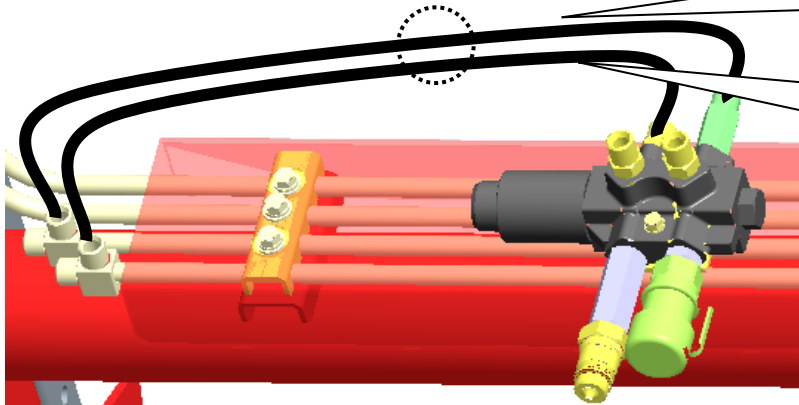

N011 . 8640-300-037-1
Hydraulic hose(670/90°), 2EA

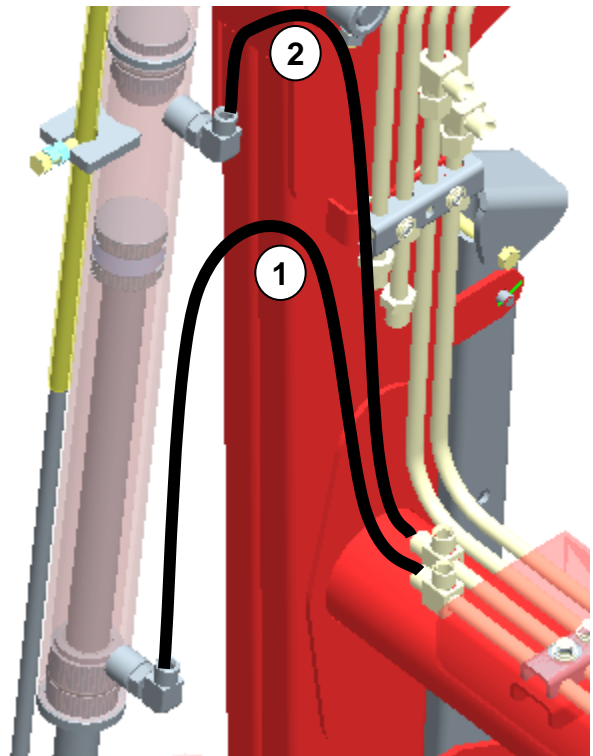

1: No14. 8540-300-037-0 (820 mm / 90°)
2: No 15. 8600-300-405-1 (980 mm / 90°)

6. Assembly of 3rd Function Harness

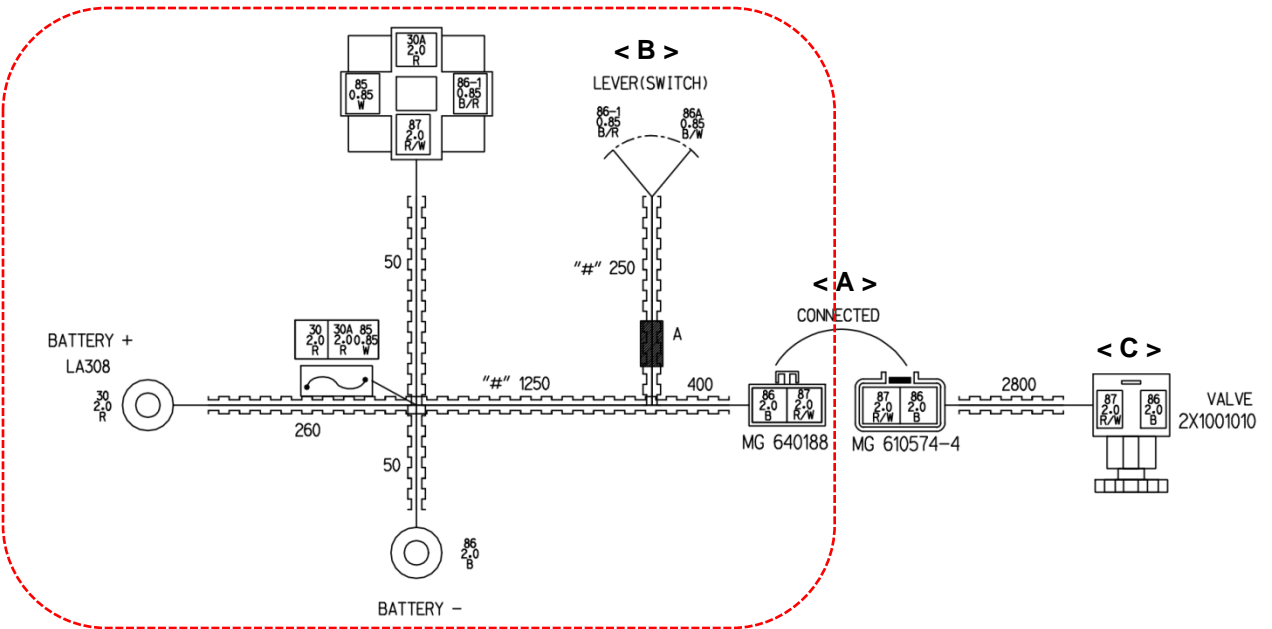

Connect with Harness of joystick lever

Link up with harness which has connected Loader boom ASSY

Should be 40A relay clasping

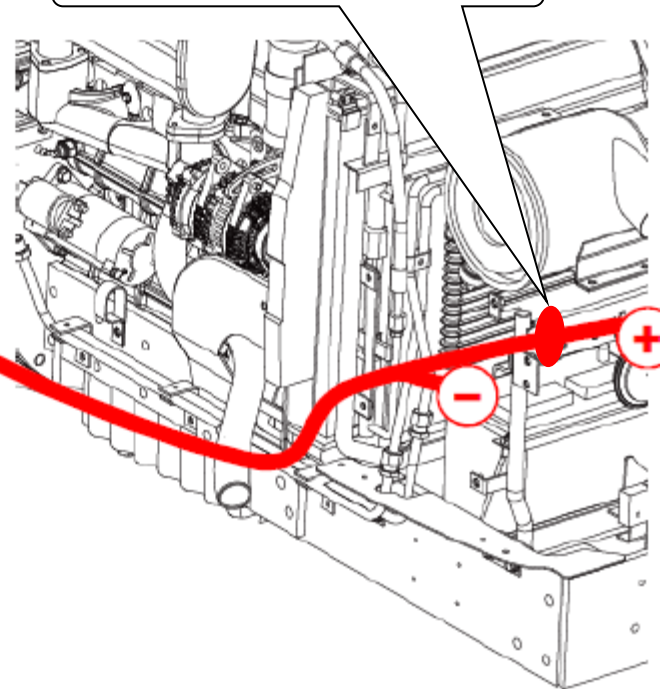
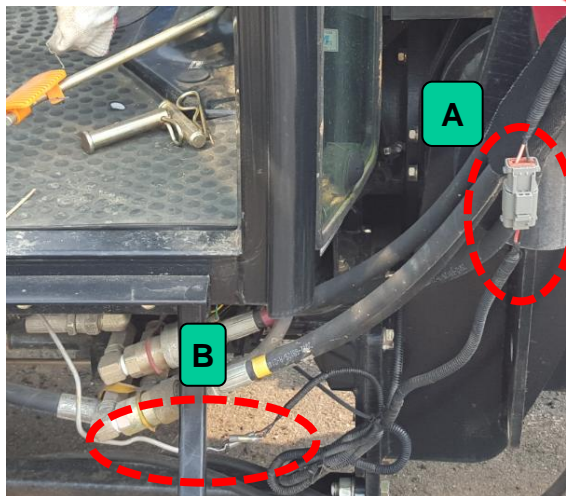

6. Assembly of 3rd Function Harness

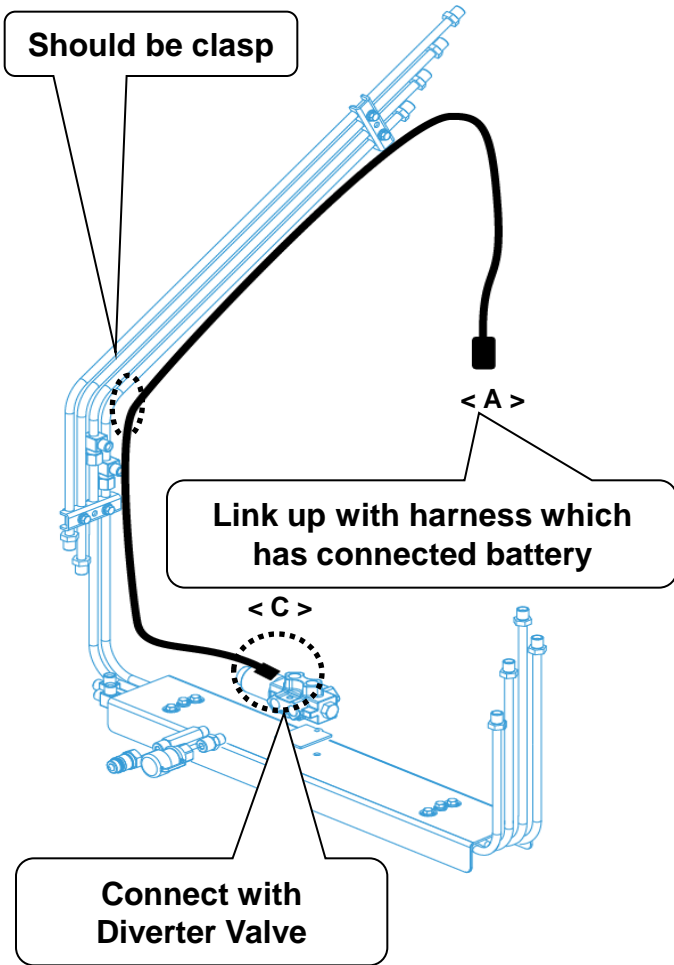
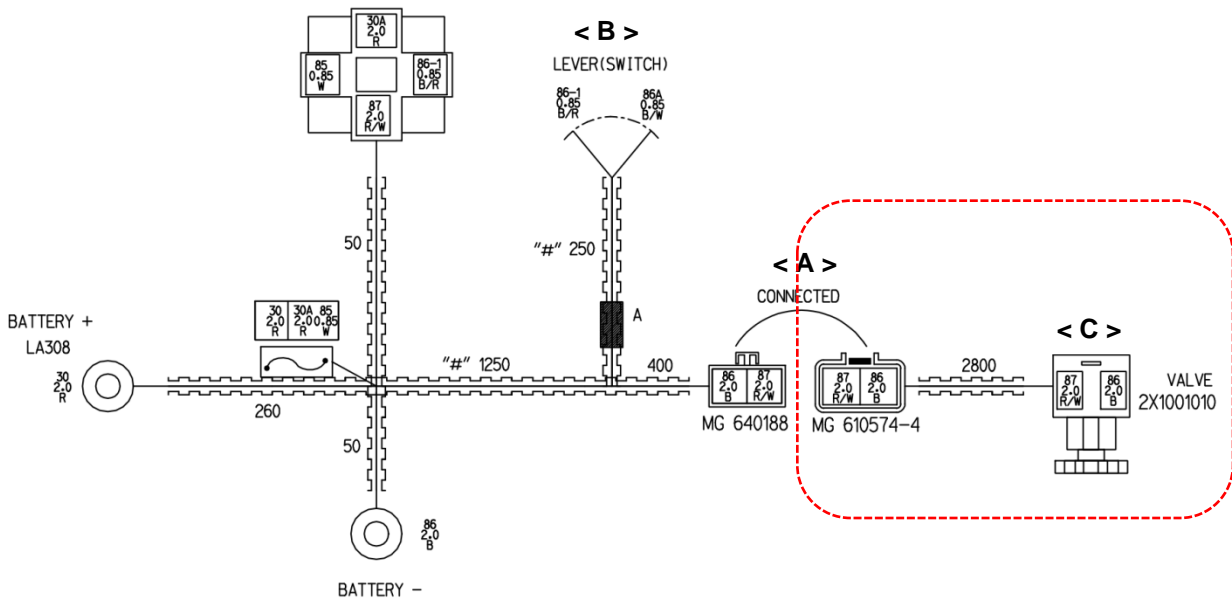

Remove Cap of valve



Tighten the screws after connecting the harness terminal "C"

